

# SKILLS-EXPERIENCE

Mark Robert Synan BA (Hons) Dip LA, CMLI, BCSLA, CSLA

PURPOSE • INSPIRE • IMPROVE LIVES • LEAVE SIGNATURE • ENJOY



## CONTACT

T. 07948472998

A. Flat 53 Webcourt, 3 Queensway, Southampton SO14 3QX



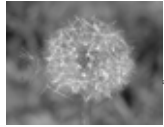

# Project experience

VARIETY OF PROJECT EXPERIENCE GAINED TO DATE

**“ The difference between something good  
and something great is attention to detail”  
- Charles R Swindoll**

*Over a 16 year period, organised, managed, and assisted on a wide variety of landscape projects in England, BC Canada, Wales, Northern Island, and voluntary work in Ecuador. Project experience ranges from award winning park and recreational development, residential, hospitals, business parks, historic cemetery restoration, highway proposals and park and rides.*

*The following work examples provide a broad range of experience gained to date. A portfolio of work is available for presentation that provides a more detailed explanation of the projects. All documents, text, and drawings have been prepared by myself or as part of a team.*





# Project Locations

LOCATIONS WHERE PROJECT EXPERIENCE HAS BEEN OBTAINED

*The selection of Landscape Architect based projects below represents the top 50 projects worked on to date. The projects selected have either involved full project management, or assisted on the projects. Private gardens and Construction based experience has not been provided.*

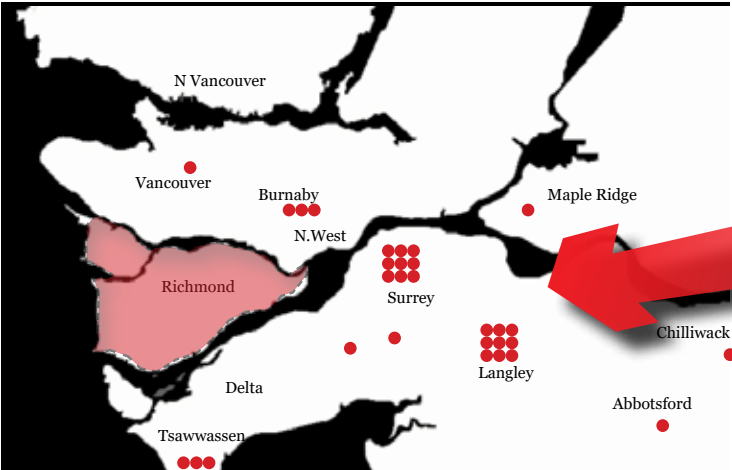

Vancouver Lower Mainland, BC, Canada

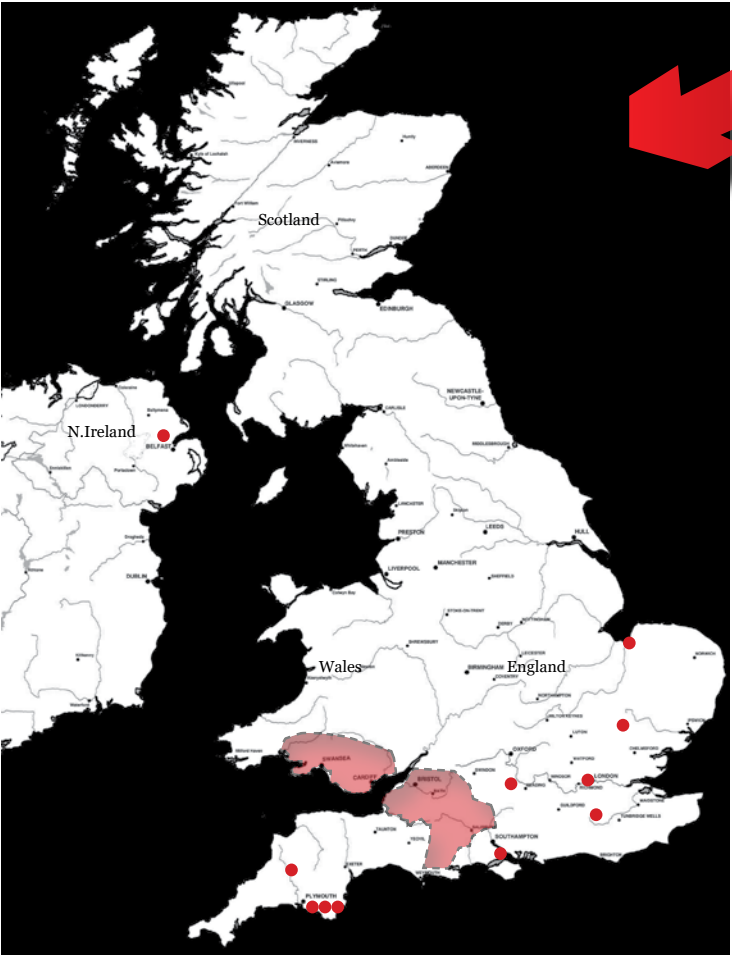

United Kingdom

- Legend
- 50+ Projects
  - 1-2 Projects



## Parks and recreation

- Holland Park Sister Cities, Surrey, Canada
- Holland Park Playarea, Surrey, Canada
- Lisburn Castle Gardens, Belfast, N.Ireland
- Edmonds Park Plaza, Burnaby, Canada
- Tamanawis Park, Surrey, Canada
- Zhengzhou International Expo (Plot J16), China

## Health care and Ecclesiastics

- Frome Hospital, Frome, England
- Arnos Vale Cemetery, Bristol, England
- Kinsmen Care Facility, Surrey, Canada
- Northgate Seniors Building, Tsawwassen, Canada

## Public facilities

- Edmonds Pool Community Centre
- Swanage and Dorchester Recycling Centres (5 in total)
- Eastern Business Park, Cardiff, Wales
- Electricity Club, Cardiff, Wales

## Towers & Residential

- Park Place Towers, Surrey, Canada
- King George Development, Surrey, Canada
- Alderbridge Towers, Richmond Canada
- Civic Plaza 3, Surrey Canada
- Cargo Millbay, Plymouth, England
- 1400 homes at Bury St Edmunds, England
- Freshford Mill, Bath, England
- Riverport Flats 5, Richmond, Canada
- Centro Terrawest, Richmond, Canada
- Northgate, Tsawwassen, Canada
- Hanham Development, Bristol, England
- Mycynys Coastal Village, Llanelli, Wales
- Southlands, Tsawwassen, Canada
- Brockworth Town, Gloucester, England
- Queensgate North, Cardiff, Wales
- Francis Road, Richmond, Canada
- Gateway Tower, Surrey, Canada

(\* Numerous small townhomes/housing schemes (10-50 home range) involving planting and hard-scape design. This was mainly in South Wales, South England, and the Lower mainland of Vancouver)

## Environmental, Ecological, SDS

- Plymouth Attenuation Basin, Plymouth, England
- (\* Numerous Sustainable drainage systems, ecological designs with many of the Tower and residential projects)
- Voluntary Work Rainforest, Amazon Basin, Ecuador

## Transport and ROW

- Salisbury and Bath Park and Rides
- (5 in total) and LRT
- Penarth Headland Link, Penarth, Wales
- Bodmin Mor to Higher Carblake, Devon, England

## Environmental Assesments and Expert Witness\*

- Salisbury Park and Ride Environmental Statement
- DMRB road Assesments for Interoute (over 20 assess-ments)
- Penarth Headland link Environmental Statement
- Bath Housing Assessment, Bath, England

## Clients

- (2 or more projects based in Canada only)
- City of Burnaby
- City of Surrey
- PCI
- Amacon
- Century Group
- Cotter Architects
- Legacy Lands
- BOSA
- Concord Pacific
- IBI

## Municipaties

- City of Vancouver
- City of Burnaby
- City of Surrey
- City of Richmond
- Township of Langley
- Corporation of Delta

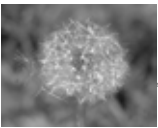

# Presentations

PRESENTATION EXPERIENCE AT PLANNING AND PUBLIC CONSULTATION EVENTS



Bath Park and Ride proposal (above)



## AN INTRODUCTION TO TREES AND THE LAW

An introduction to trees and the law

NICHOLAS PEARSON ASSOCIATES

### Presentations to Landscape Institute Candidates, UK (2009)

Presentations to 10-15 Landscape Institute Examination Candidates on 'An Introduction to Trees and the Law' using powerpoint. Organised workshops, aural examinations, and assisted a number of candidates preparing for their examination for membership into the British Landscape Institute.

### Public Inquiries and Expert Witness

Cranes farm expert witness (Assisting Director) (2003).

An appeal after an enforcement notice was issued to demolish a barn conversion in Berkshire, England, located in an AONB. Assisted a Director preparing a proof of evidence, LVIA, and all other documents. Attended the public inquiry, assisting the director on his 3 day attendance.

## Presentations

### DP/Rezoning Application Presentations, Canada (2010-2017)

Presentations to Advisory Design Panels, Planning Committees, Public Consultations for Rezoning & Development Permit Applications in Richmond, Surrey and Delta (5 projects in total)

### Public Presentations/Exhibitions, Canada and UK (2002-2017)

Presentations using graphic display boards and poweppoint presentations for public consultation events for rezoning/DP applications, and Municipality Parks and Recreation proposals in Canada.

- Zhengzhou 2017 expo Plot J16 - Presentation of the design to the Zhengzhou International Airport Commitee and mayor, and City of Richmond Mayor.

- Several display board presentations for Artificial Sports Fields in Surrey and New Westminster, Canada.

- Public presentations for a highly controversial transport strategy locating 5 park and rides and a rapid transit route within the World Heritage Site of Bath City, England and a 750 space Park and Ride in Salisbury England

- Public exhibition presenting display boards to the public, MP's, and other local government representatives for Housing planning applications in Bristol, England.



Hanham Housing proposal photomontage (Above)





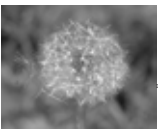

# Planning

PLANNING/PERMIT APPLICATION EXPERIENCE

## Rezong/DP/BP Applications, Canada (2010-2014)

Project Managed the preparation of Rezoning, Development Permit, and Building Permits in Richmond, Burnaby, Surrey, Delta, Langley, and Abbotsford.

Typical applications have involved drawing preparation, bonding estimates, servicing agreements, preparation for ADP and planning committees, stormwater management calculations, LEED compliance, meeting attendance, responding to Municipality comments, liaising with consultants throughout the process, and supervision of staff during applications.

## Outline/Detailed Planning Applications, UK (2002-2009)

Project managed and assisted on a number of planning applications in England and Wales.

Applications included drawing preparation, Design and Access Statements, public consultation events, 106 agreements, LVIA and Environmental statements, consultation with design team and planning officers.

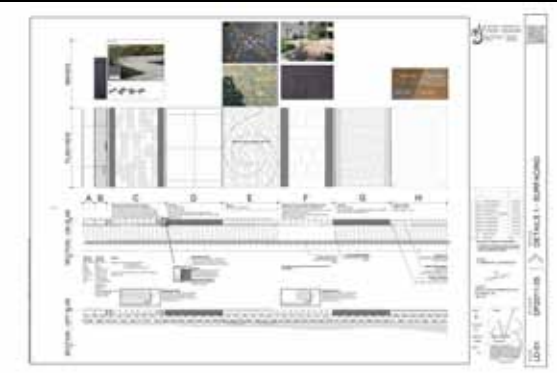

ADP presentation:  
Alderbridge Rezoning ADP boards (2012)  
- Above, Existing street views and landscape assessment  
- Right and topright, Site analysis boards

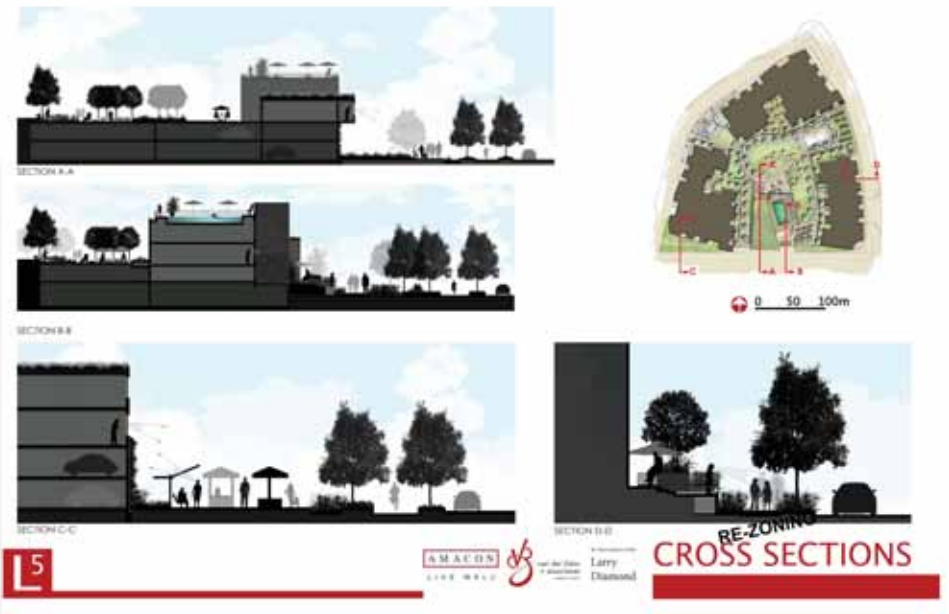
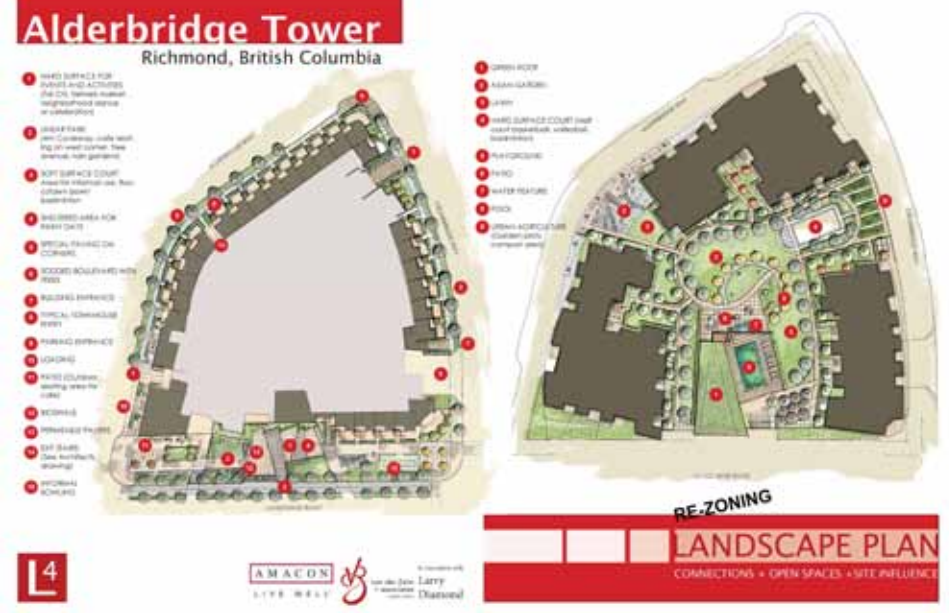

Alderbridge ADP presentation (2012):  
- Above, Landscape Masterplan for both the streetlevel, and upper podium. A series of cross sections has also been shown.

Alderbridge DP submission (2012-2013)  
- Far left, DP coverpage and an extract from one of the landscape detail pages illustrating the variety of surface treatments proposed on the project  
- Left, Landscape Masterplan

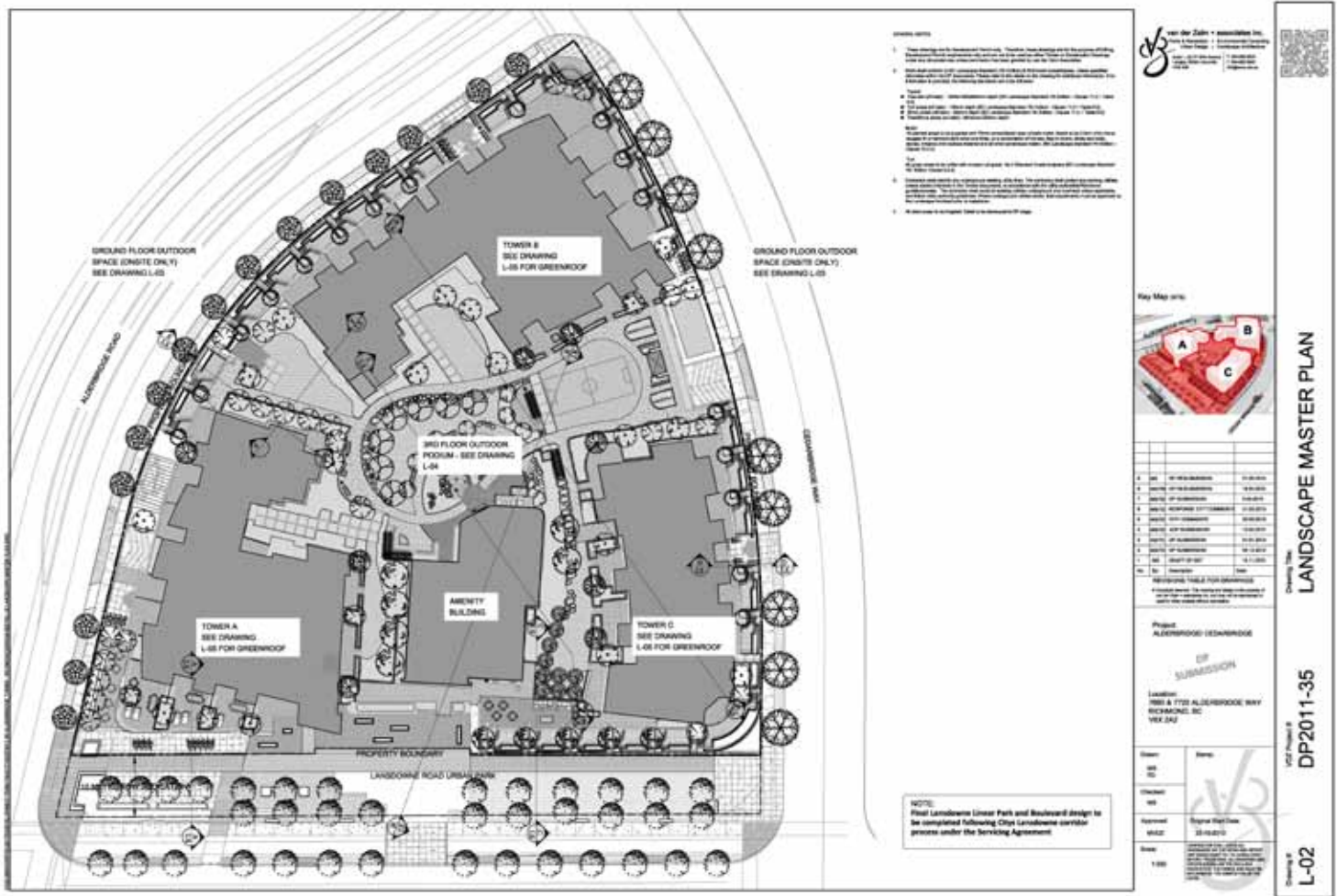



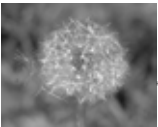

# CA & Tender

EXPERIENCE DURING TENDER AND CONSTRUCTION PROJECT STAGES

Acted as either a Contract Administrator, Project Landscape Designer, or assisted staff for a number of Construction projects over a 12 year period. During the role of the Contract Administrator, this typically involved preparing and overseeing IFC packages, running pre-construction and progress meetings, preparing and issuing contract paperwork (CO's, CCO's, SI's, RFI's), processing payment certificates, site inspections and substantial completion reviews. Roles in the project also included project managing other disciplines engaged in the contract, and ongoing communication with both client and contractor.

Tender experience includes both Project Managing Tender submissions for both private and municipal clients. Experience liaising with City of Burnaby and Surrey Purchasing Departments in BC Canada, and extensive experience using JCT Practice Note 6 in the United Kingdom



## Contract Administration Experience

Appointed Contract Administrator on the following projects:

- Lang Park, Client and site inspections: CCDC (2016-2017)
- Edmonds Park Plaza, Contract:CCDC (2013-2016)
- Edmonds Park Playarea, Contract:CCDC (2014-2016)
- Southlands Display Home, Contract CCDC 14 (2012)
- Century Village refurbishment, Contract CCDC 14 (2012)
- Arnos Vale Cemetery, Contract JCT intermediate (2006-2008)
- Plymouth Attenuation Basin, Contract JCLI (2005)
- Electricity and Social Club, Contract JCLI (2003)

Also assisted Architects, Landscape Architects, and Civil Engineers on over 20 construction projects between 2002-2014, providing RFIs, assisted with CCOs and CO's, SI's, site reviews, substantial completion reviews, and attended pre-construction and progress meetings.

## Tender Experience

Directly organised as project coordinator the following Tenders:

- City of Richmond Tender Submissions (2016-2017). 2 Tenders in total (Aberdeen Park, West Cambie Park)
- City of Burnaby Tender Submissions (2013-2014). 2 Tenders in total.
- Practice Note 6 (JCT) Tender submissions (2003-2006) in the United Kingdom. 5 Tenders in total

Also assisted lead consultants on over ten tenders for the preparation of Tender Drawings, and specifications. Answered Tender queries and issued Tender addendums on a number of projects between 2002-2014.

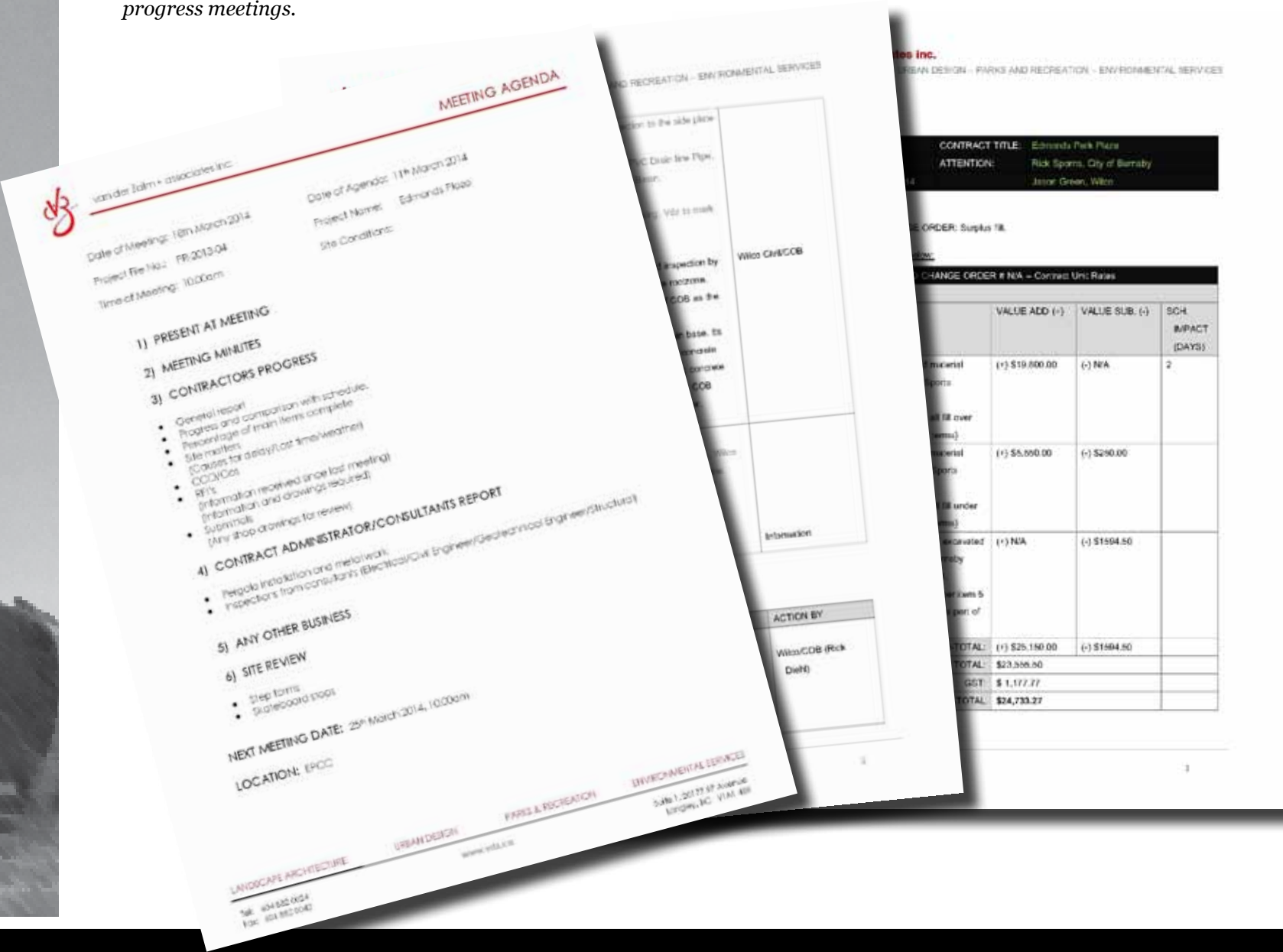



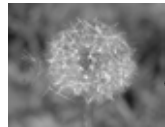

# Report Preparation

LANDSCAPE ASSESSMENT AND DOCUMENT PREPARATION

The following are a selection of examples of my involvement in report preparation, which included clients such as the UK Government, Government Agencies, and Councils.

## Environmental Assessments:

- Penarth Headland Link (2003)
- Swanage Household Recycling Centre (2009)
- Salisbury Park and Ride (2006)
- Bradwell Nuclear Power Station Extension Assessment (2009)
- Bodmin Mor Road Proposal (2002)

## Feasibility Assessments:

- Proposed Regional Town Locations (2009)

## Design & Access Statements:

- Bath Rapit Transit Route (2008)
- Salisbury Park and Ride (2006)



Penarth Headland Link  
Environmental Assessment (NTS)



Salisbury Park and Ride Design Statement -  
Materials palette (Top & Bottom Right)

Land West of Bath - Landscape Character  
Assessment (Top Left)

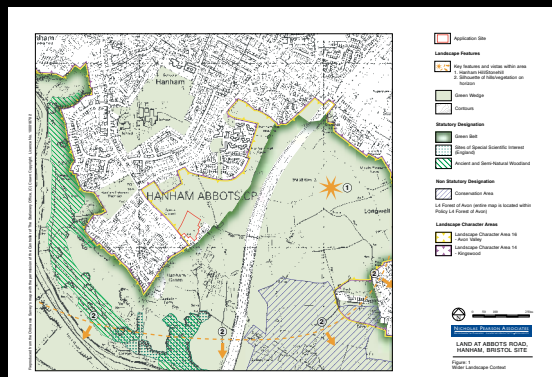

Land West of Bath - Visual Appraisal (Above)

Hanham Housing proposal - Landscape Character  
Assessment (Bottom left)



Salisbury Park & Ride Environmental  
Assessment (NTS)



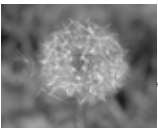

# Construction

IMPLEMENTATION EXPERIENCE.

Please see a construction CV for our construction experience. We have a variety of implementation experience during 2009 and 2010 preparing a number of high profile 2010 Winter Olympic Sites, residential and commercial projects, and private gardens. This involved day to day site experience on high pressured construction sites which constantly involved problem solving, working in teams, planning and organising, and liaising with clients. The valuable knowledge gained has harnessed landscape detailing skills and provided a clearer understanding how to produce improved construction drawing packages that effectively communicates the designers intent to the contractor.



Convention Centre, Vancouver



Robson Square, Vancouver



Erickson Condo development, Vancouver

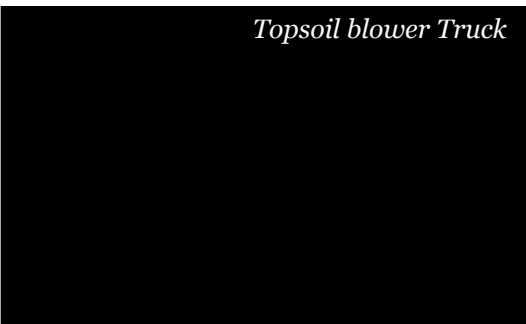

Topsoil blower Truck



Convention Centre, Vancouver



Convention Centre, Vancouver



Oak & 43rd Housing Scheme, Vancouver